

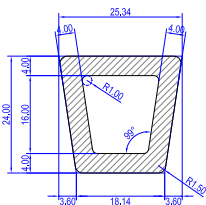

WPC CORNER COLUMN FILLER

Used to fill unused gaps in the WPC fencing corner column

- 100% Recyclable, Environmentally friendly
- Cost-effective
- Minimal to zero maintenance
- Orderless, UV resistance, Stain resistance, Anti-slippery, No rotting, No splintering



FPF-0

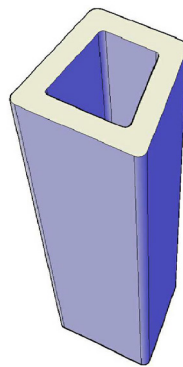
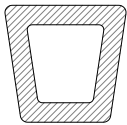

Product Family

WPC FENCING COLUMN FILLER

Related Products

WPC FENCING COLUMN

WPC FENCING CORNER COLUMN

WPC GROVER CENTER PROFILE

WPC FENCING TOP CLOSER PROFILE

WPC FENCING MIDDLE SEPARATOR PROFILE

WPC MALE-FEMALE FENCE SEPARATOR

WPC FEMALE-FEMALE FENCE SEPARATOR

WPC MALE-MALE FENCE SEPARATOR

WPC FENCING COLUMN FILLER

WPC CENTER PROFILE

WPC FENCING BOTTOM PROFILE

WPC FENCING COLUMN CAP

Quality

All our products are produced in quality controlled environment taking into consideration food safety and hygiene standards under certified ISO 9001:2000 & ISO 9001:2008 and GMP quality management system. Our Quality System is regularly audited by third party.



Disclaimer

Consumer Safety is extremely important for Industrium. Therefore all our food-contact materials and articles are produced taking into consideration national and international regulations, and do not transfer their constituents to the food under normal or foreseeable conditions of use. The foregoing data are without engagement and constitute the best of our knowledge; they are reliable if applied correctly and adapted to local conditions and cannot be taken as any guarantee, since the processing at the end-user are beyond our control. The above mentioned guidelines are supplied to assist the buyer in determining the proper use of products. However, because every food supplier's recipes, ingredients, processes and supply chain are unique, these guidelines are not a substitute for product testing. Confirmation of product acceptability under customer's specific conditions of use must be done by the customer.

Properties

Material	: Wood Plastic Composite
Material composition	: Wood powder <60% High-Density Polyethylene <40% Inert Proprietary Ingredients <10%
Manufacturing Process	: Extrusion
Length (mm)	: Recommended: 2100 Customizable
Width (mm)	: 23.35 - 18.14
Height (mm)	: 24.00
Weight (kg/m)	: 0.35 ± 5%
Density (g/m ³)	: > 1.1
Color(s)	: Standard: Brown, Grey Customizable
Surface finish	: Plain

Packaging

Packaging : Plastic Shrink Wrap

Ordering Option(s)

Custom Color
Custom Length
Fire Rated/Not Fire Rated